

Type 086

Screw type terminal block, solderable, centerline 3.81 mm / 0.150 inches, horizontal wire entry, lift system

Technical Data

0.12 - 1.5 mm² 130 V / 2,5 kV / 12 A

Insulation co-ordination according to EN 60664-1

Clearance and creepage distances	min. 2 mm		
Insulating material class	CTI 600		
Overvoltage category	III	III	II
Pollution degree	3	2	2
Rated voltage	160	400	400
Rated test voltage	2.5	4	2.5

Protection category according to IEC 529

IP00

Tightening torque UL 1.3 lb-in max.

Min. insul. strip length 5 mm

Solder pin dimension 0.5 x 0.9 mm

Recommended pc board hole dia.

Ø 1.1 mm

Solder pin length 3.5 mm

Pole size 2 - 24

Color black

Dimensions in mm

1 mm = 0.0394 in.

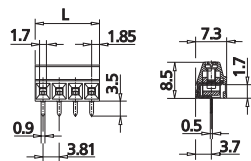

L = (pole size - 1) x centerline + 3.81 mm / 0.150 inches

Part numbers (P/N)

(information: page 56)

Complete the part number by adding the pole size.

Type 086

centerline 3.81 mm / 0.150 inches

P/N 310861

	02	03	04	05	06	07	08
	09	10	11	12	13	14	15
	16	17	18	19	20	21	22
	23	24					

* approval pending

Standard pole sizes

Available on demand. Minimum order quantity 5000 pieces per item.

A