

## AST178

Spring clamp terminal block, solderable, centerline 7.62 mm / 0.300 inches, wire entry 60 °, double solder pins

### Technical Data

	0.08 - 2.5 mm <sup>2</sup> 500 V / 6 kV / 16 A		
Insulation co-ordination according to EN 60664-1			
Clearance and creepage distances	min. 7.12 mm		
Insulating material class	CTI 600		
Overvoltage category	III	III	II
Pollution degree	3	2	2
Rated voltage	500	1250	1250
Rated test voltage	4	8	6
Protection category according to IEC 529			
	IP20		
Min. insul. strip length	15 mm		
Solder pin dimension	2 x 0.5 x 1.0 mm		
Recommended pc board hole dia.	Ø 1.4 mm		
Solder pin length	4 mm		
Pole size	2 - 24		
Color	grey		

## AST188

Spring clamp terminal block, solderable, centerline 7.62 mm / 0.300 inches, wire entry 60 °, two contacts per pole, double solder pins

### Technical Data

	0.08 - 2.5 mm <sup>2</sup> 500 V / 6 kV / 16 A		
Insulation co-ordination according to EN 60664-1			
Clearance and creepage distances	min. 7.12 mm		
Insulating material class	CTI 600		
Overvoltage category	III	III	II
Pollution degree	3	2	2
Rated voltage	500	1250	1250
Rated test voltage	4	8	6
Protection category according to IEC 529			
	IP20		
Min. insul. strip length	15 mm		
Solder pin dimension	2 x 0.5 x 1.0 mm		
Recommended pc board hole dia.	Ø 1.4 mm		
Solder pin length	4 mm		
Pole size	2 - 24		
Color	grey		

Dimensions in mm 1 mm = 0.0394 in.

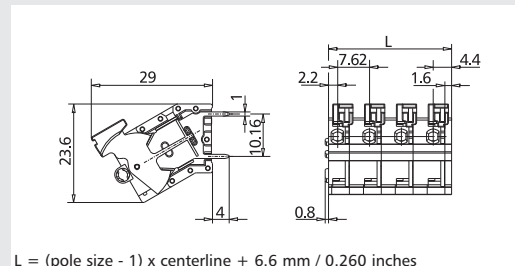

$L = (\text{pole size} - 1) \times \text{centerline} + 6.6 \text{ mm} / 0.260 \text{ inches}$

Dimensions in mm 1 mm = 0.0394 in.

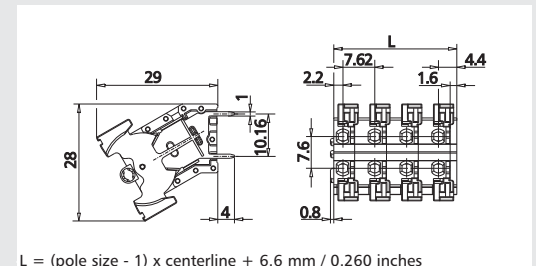

$L = (\text{pole size} - 1) \times \text{centerline} + 6.6 \text{ mm} / 0.260 \text{ inches}$

### Part numbers (P/N)

(information: page 16)

Complete the part number by adding the pole size.

#### AST178

centerline 7.62 mm / 0.300 inches

P/N AST178

	02	03	04	05	06	07	08
	09	10	11	12	13	14	15
	17	18	19	20	21	22	23
	24						

\* approval pending

### Part numbers (P/N)

(information: page 16)

Complete the part number by adding the pole size.

#### AST188

centerline 7.62 mm / 0.300 inches

P/N AST188

	02	03	04	05	06	07	08
	09	10	11	12	13	14	15
	17	18	19	20	21	22	23
	24						

\* approval pending

Standard pole sizes  
 Available on demand. Minimum order quantity 5000 pieces per item.

Standard pole sizes  
 Available on demand. Minimum order quantity 5000 pieces per item.