

AST145

Spring clamp terminal block, solderable, centerline 5 mm / 0.197 inches, vertical wire entry, two individual contacts per centerline, double solder pins

Technical Data

UL US V / A / AWG 300 / 17 / 28 - 14

0.08 - 2.5 mm² 450 V / 4 kV / 22 A

Insulation co-ordination according to EN 60664-1

Clearance and creepage distances min. 4.5 mm

Insulating material class CTI 600

Overvoltage category III III II

Pollution degree 3 2 2

Rated voltage 320 800 800

Rated test voltage 4 6 4

Protection category according to IEC 529 IP20

Min. insul. strip length 12 mm

Solder pin dimension 2 x 0.5 x 1.0 mm

Recommended pc board hole dia. Ø 1.4 mm

Solder pin length 3.2 mm

Pole size 2 - 48

Color grey

Dimensions in mm 1 mm = 0.0394 in.

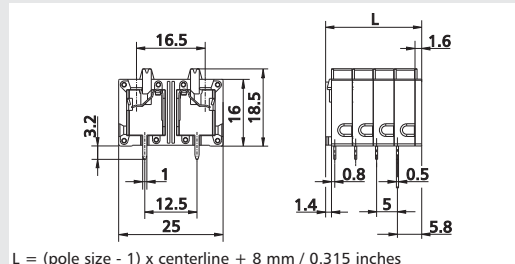

$L = (\text{pole size} - 1) \times \text{centerline} + 8 \text{ mm} / 0.315 \text{ inches}$

Part numbers (P/N)

(information: page 16)

Complete the part number by adding the pole size.

AST145

centerline 5 mm / 0.197 inches

P/N AST145

02	04	06	08	10	12	14	16
18	20	22	24	26	28	30	32
34	36	38	40	42	44	46	48

* approval pending

Standard pole sizes

Available on demand. Minimum order quantity 5000 pieces per item.

AST215

Spring clamp terminal block, solderable, centerline 5 mm / 0.197 inches, vertical wire entry, double solder pins

Technical Data

0.25 - 1.5 mm² 250 V / 4 kV / 12 A

Insulation co-ordination according to EN 60664-1

Clearance and creepage distances min. 3.4 mm

Insulating material class CTI 600

Overvoltage category III III II

Pollution degree 3 2 2

Rated voltage 250 630 630

Rated test voltage 2.5 6 4

Protection category according to IEC 529 IP20

Min. insul. strip length 8.5 mm

Solder pin dimension 0.4 x 0.8 mm

Recommended pc board hole dia. Ø 1.2 mm

Solder pin length 3.5 mm

Pole size 2 - 12

Color black

Dimensions in mm 1 mm = 0.0394 in.

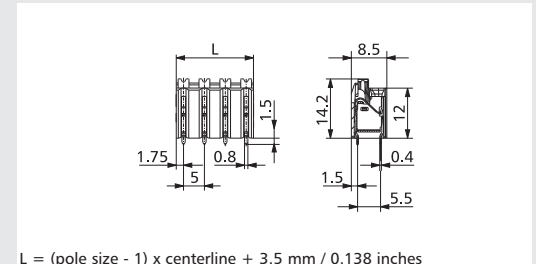

$L = (\text{pole size} - 1) \times \text{centerline} + 3.5 \text{ mm} / 0.138 \text{ inches}$

Part numbers (P/N)

(information: page 16)

Complete the part number by adding the pole size.

AST215

centerline 5 mm / 0.197 inches

P/N AST215

	02	03	04	05	06	07	08

* approval pending

Standard pole sizes

Available on demand. Minimum order quantity 5000 pieces per item.