



AST225

Spring clamp terminal block, solderable, centerline 5 mm / 0.197 inches, horizontal wire entry, double solder pins

Technical Data

0.25 - 1.5 mm² 250 V / 4 kV / 12 A

Insulation co-ordination according to EN 60664-1

Clearance and creepage distances	min. 3.4 mm		
Insulating material class	CTI 600		
Overvoltage category	III	III	II
Pollution degree	3	2	2
Rated voltage	250	630	630
Rated test voltage	2.5	6	4

Protection category according to IEC 529

IP20

Min. insul. strip length	8.5 mm
Solder pin dimension	0.4 x 0.8 mm
Recommended pc board hole dia.	Ø 1.1 mm
Solder pin length	1.5 mm
Pole size	2 - 8
Color	black

Dimensions in mm 1 mm = 0.0394 in.

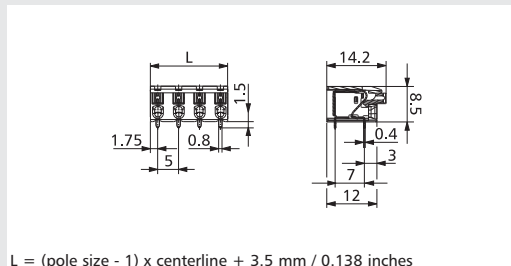

$L = (\text{pole size} - 1) \times \text{centerline} + 3.5 \text{ mm} / 0.138 \text{ inches}$

Part numbers (P/N)

(information: page 16)

Complete the part number by adding the pole size.

AST225

centerline 5 mm / 0.197 inches

P/N AST225

	02	03	04	05	06	07	08
<input type="text"/>							

* approval pending

- Standard pole sizes
- Available on demand. Minimum order quantity 5000 pieces per item.

A